

NORTH EVERETT MIDDLE SCHOOL GYM • Everett, WA
 Phillip Lehn Project Architect, NAC | Architecture • Seattle

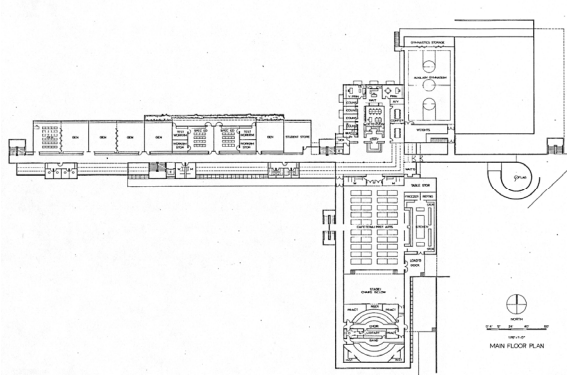

HEATHERWOOD MIDDLE SCHOOL • Mill Creek, WA
 Phillip Lehn, Project Architect, Botesch, Nash & Hall

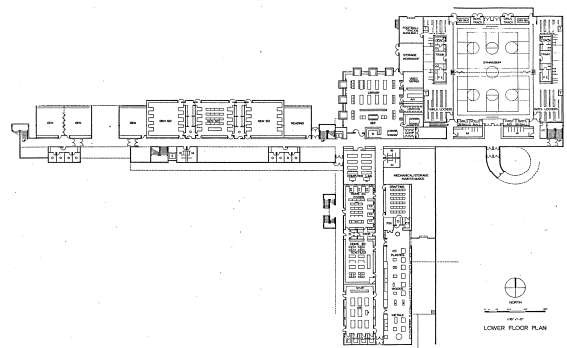

EVERETT HIGH SCHOOL SCIENCE BUILDING • Everett, WA
 Phillip Lehn, Project Architect, Botesch, Nash & Hall



ADDITION & IMPROVEMENTS TO CASCADE HIGH SCHOOL SCIENCE BUILDING • Everett, WA / Phillip Lehn Project Architect:
 Facility assessment, program development, design and construction drawings, Botesch, Nash & Hall • Everett, WA